

NO DIMENSIONS TO BE SCALED FROM THIS DRAWING.
CDM - REDIAL HAZARD The drawing are considered to be significant and relevant to the drawing which could not be fully mitigated or removed through design.

CDM - REDIAL HAZARD

1		
2		
3	date:	

Further possible control measures have been identified where the Design Risk further during the construction / maintenance process.

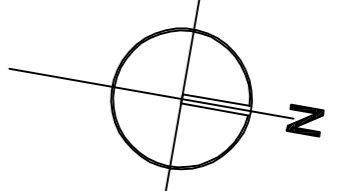

- New external walls
- New internal walls
- Blocked opening in external wall
- Blocked opening in internal wall
- New door to existing wall
- New door to new wall
- New window to existing wall
- New window to new wall
- Demolished walls and doors

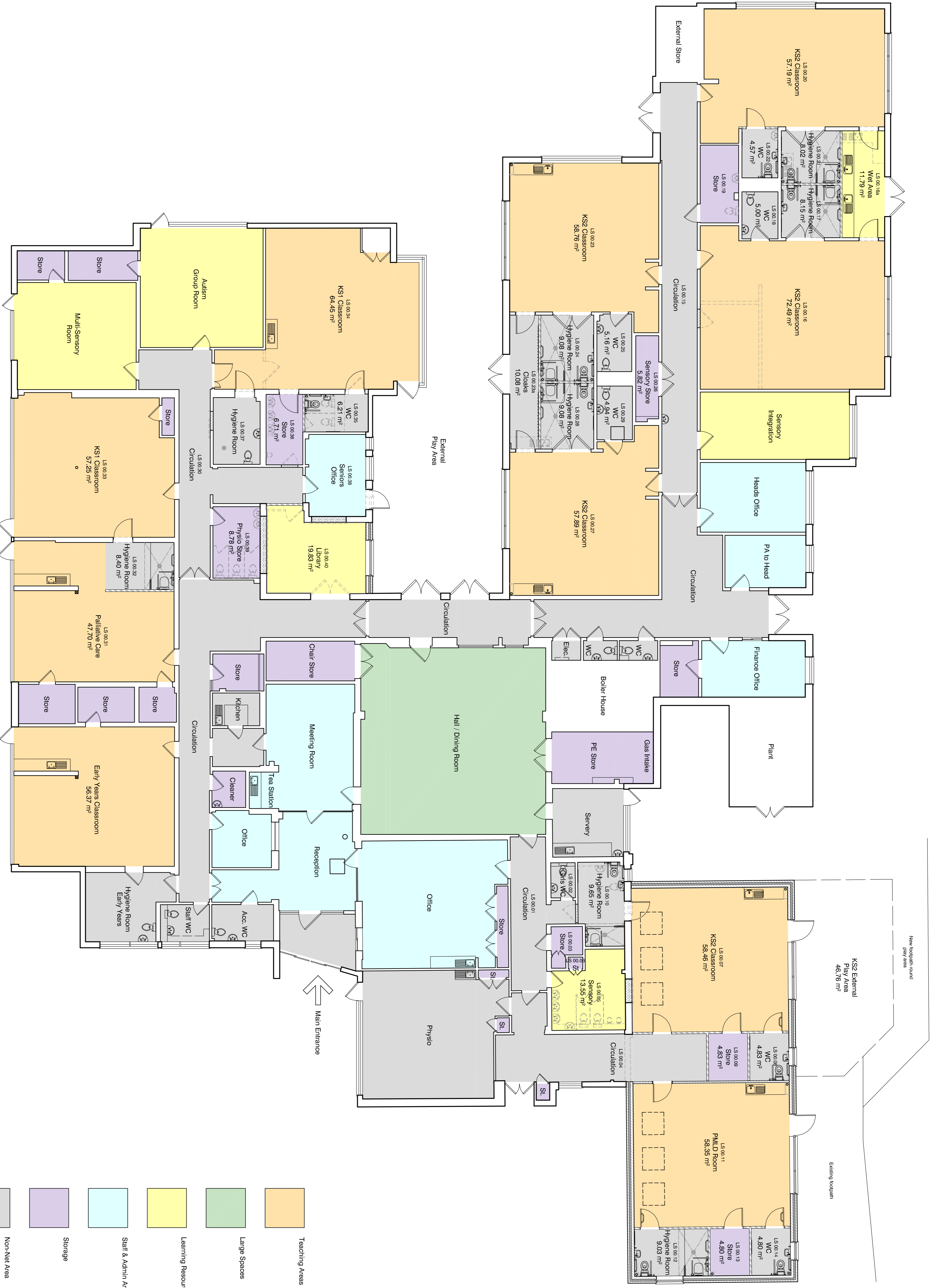

- Teaching Areas
- Large Spaces
- Learning Resource Areas
- Staff & Admin Areas
- Storage
- Non-Net Area

Revision	Date	By	Check
R10	17.12.18	CPH	KPB
R9	17.12.18	CPH	KPB
R8	20.11.18	CPH	KPB
R7	19.11.18	CPH	KPB
R6	12.11.18	CPH	KPB
R5	11.10.18	CPH	KPB
R4	26.08.18	CPH	KPB
R3	14.05.18	CPH	KPB
R2	09.05.18	CPH	KPB
R1	08.05.18	CPH	KPB

Send us your comments to
Cambridgeshire County Council
 Project:
Extension and Alterations to Spring Common Academy, Huntingdon
 Drawing Title:
PLAN PROPOSED- GA-00 (GROUND) LOWER SCHOOL

S2 - Suitable for Information
 Scale: **1:100**
 Drawing Number: **142557-PEV-B1-00-DR-A-9200**
 Project Code: - Original - Zone - Level - Type - Risk - Number